

DEVELOPMENT APPLICATION

PROPOSED BATTERY STORAGE FACILITY

RIVERSIDE DRIVE MAYFIELD WEST

PROPOSED LOT 1102
SUBDIVISION OF LOT 12 DP 280089

DRAWING SCHEDULE			
PROJECT	SHEET	TITLE	REVISION
20269A	DA01	SITE PLAN	9
20269A	DA02	PERSPECTIVE VIEWS	9
20269A	DA03	VEHICLE MOVEMENT PLAN	9
20269A	DA04	VEHICLE MOVEMENT PLAN	9
20269A	DA05	VEHICLE MOVEMENT PLAN	9
20269A	DA06	BATTERY MODULE OPTION	9



LOCALITY PLAN
NOT TO SCALE



Council
NEWCASTLE CITY COUNCIL

Client
STEEL RIVER WEST PTY LTD



GCA Engineering Solutions
1 Hartley Drive (PO Box 3337),
Thornton NSW 2322
Ph 02 4964 1811
www.gca.net.au

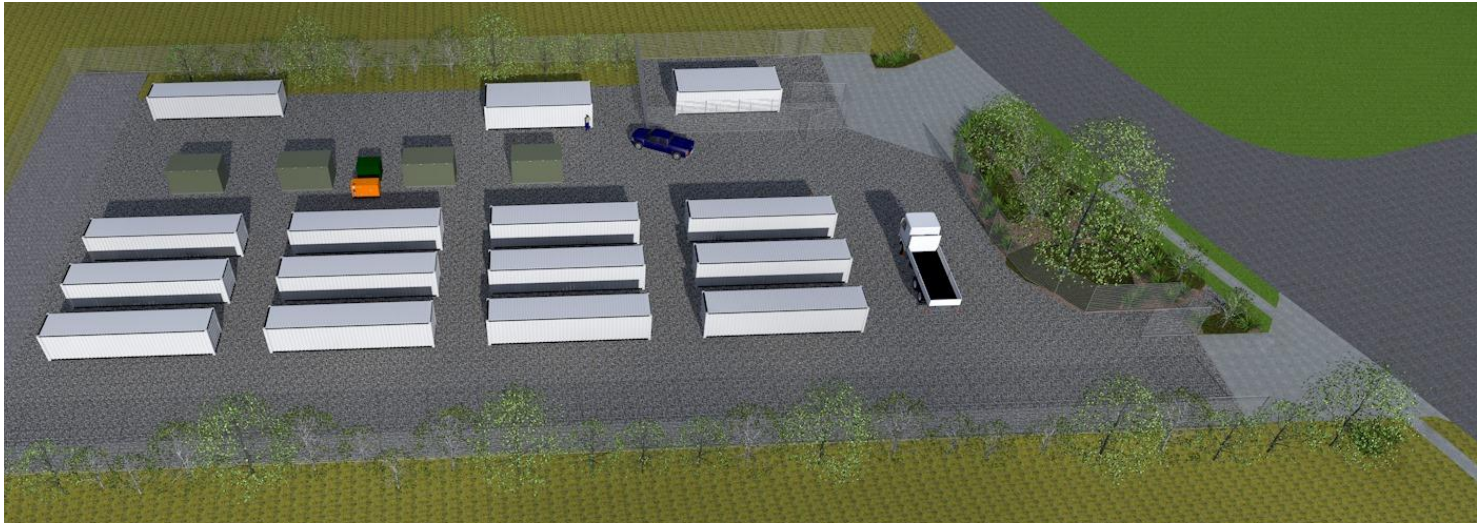

9	22.06.21	10M OFFSET & NOTE ADDED	BB
8	28.05.21	GENERAL REVISIONS	BB
REV.	DATE	DESCRIPTION	DRAWN

20269A DAr9.pln Last saved on 1/06/2021 by Mark

COPYRIGHT IN THE DRAWINGS, INFORMATION AND DATA RECORDED HEREON IS THE PROPERTY OF GEOFF CRAIG & ASSOCIATES PTY LTD AND MAY NOT BE USED, COPIED OR REPRODUCED IN WHOLE OR PART FOR ANY PURPOSE OTHER THAN THAT FOR WHICH IT IS SUPPLIED WITHOUT THE PRIOR CONSENT OF GEOFF CRAIG & ASSOCIATES PTY LTD.





GCA
ENGINEERING SOLUTIONS

GCA Engineering Solutions
1 Hartley Drive (PO Box 3337),
Thornton NSW 2322
Ph 02 4964 1811 www.gca.net.au

Client
STEEL RIVER WEST PTY LTD

Project Status
DEVELOPMENT APPLICATION

Drawings scaled to an A3 sheet

Project Title
PROPOSED BATTERY STORAGE FACILITY

Project Address
RIVERSIDE DRIVE MAYFIELD WEST

Drawing Title
PERSPECTIVE VIEWS

Project No.
20269A

Revision
9

Drawing No.
DA02

RAIL CORRIDOR

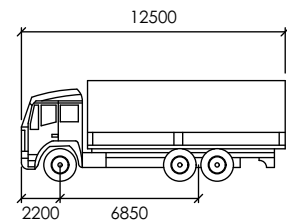

12.5m RIGID TRUCK
mm
Width : 2500
Track : 2500
Lock to Lock Time : 6.0
Steering Angle : 36.6

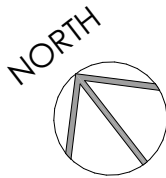

RIVERSIDE DRIVE

Scale 1:400
5 0 5 10 15 20 25m

VEHICLE MOVEMENT PLAN 1
Scale 1:400



Client
STEEL RIVER WEST PTY LTD

Project Status
DEVELOPMENT APPLICATION

Drawings scaled to an A3 sheet

Project Title
PROPOSED BATTERY STORAGE FACILITY

Project Address
RIVERSIDE DRIVE MAYFIELD WEST

Drawing Title
VEHICLE MOVEMENT PLAN

Project No.
20269A

Revision
9

Drawing No.
DA03

9 22.06.21 10M OFFSET & NOTE ADDED BB

8 28.05.21 GENERAL REVISIONS BB

REV. DATE DESCRIPTION DRAWN

20269A DAr9.pln Last saved on 1/06/2021 by Mark

COPYRIGHT IN THE DRAWINGS, INFORMATION AND DATA RECORDED HEREON IS THE PROPERTY OF GEOFF CRAIG & ASSOCIATES PTY LTD AND MAY NOT BE USED, COPIED OR REPRODUCED IN WHOLE OR PART FOR ANY PURPOSE OTHER THAN THAT FOR WHICH IT IS SUPPLIED WITHOUT THE PRIOR CONSENT OF GEOFF CRAIG & ASSOCIATES PTY LTD.

RAIL CORRIDOR

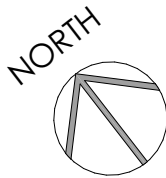
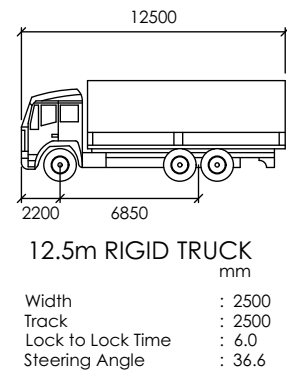

RIVERSIDE DRIVE

Scale 1:400
5 0 5 10 15 20 25m

VEHICLE MOVEMENT PLAN 2
Scale 1:400



Client
STEEL RIVER WEST PTY LTD

Project Status
DEVELOPMENT APPLICATION

Drawings scaled to an A3 sheet

Project Title
PROPOSED BATTERY STORAGE FACILITY

Project Address
RIVERSIDE DRIVE MAYFIELD WEST

Drawing Title
VEHICLE MOVEMENT PLAN

Project No.
20269A

Revision
9

Drawing No.
DA04

REV.	DATE	DESCRIPTION	DRAWN
9	22.06.21	10M OFFSET & NOTE ADDED	BB
8	28.05.21	GENERAL REVISIONS	BB

20269A DAr9.pln Last saved on 1/06/2021 by Mark

COPYRIGHT IN THE DRAWINGS, INFORMATION AND DATA RECORDED HEREON IS THE PROPERTY OF GEOFF CRAIG & ASSOCIATES PTY LTD AND MAY NOT BE USED, COPIED OR REPRODUCED IN WHOLE OR PART FOR ANY PURPOSE OTHER THAN THAT FOR WHICH IT IS SUPPLIED WITHOUT THE PRIOR CONSENT OF GEOFF CRAIG & ASSOCIATES PTY LTD.

RAIL CORRIDOR

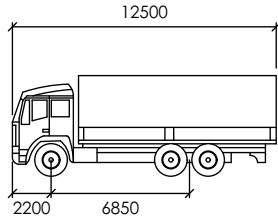

12.5m RIGID TRUCK
mm
Width : 2500
Track : 2500
Lock to Lock Time : 6.0
Steering Angle : 36.6



RIVERSIDE DRIVE

Scale 1:400 5 0 5 10 15 20 25m

VEHICLE MOVEMENT PLAN 3

Scale 1:400



GCA Engineering Solutions
1 Hartley Drive (PO Box 3337),
Thornton NSW 2322
Ph 02 4964 1811 www.gca.net.au

Client
STEEL RIVER WEST PTY LTD

Project Status
DEVELOPMENT APPLICATION

Drawings scaled to an A3 sheet

Project Title
PROPOSED BATTERY STORAGE FACILITY

Project Address
RIVERSIDE DRIVE MAYFIELD WEST

Drawing Title
VEHICLE MOVEMENT PLAN

Project No.
20269A

Revision
9

Drawing No.
DA05

REV.	DATE	DESCRIPTION	DRAWN
9	22.06.21	10M OFFSET & NOTE ADDED	BB
8	28.05.21	GENERAL REVISIONS	BB

20269A DAr9.pln Last saved on 1/06/2021 by Mark

COPYRIGHT IN THE DRAWINGS, INFORMATION AND DATA RECORDED HEREON IS THE PROPERTY OF GEOFF CRAIG & ASSOCIATES PTY LTD AND MAY NOT BE USED, COPIED OR REPRODUCED IN WHOLE OR PART FOR ANY PURPOSE OTHER THAN THAT FOR WHICH IT IS SUPPLIED WITHOUT THE PRIOR CONSENT OF GEOFF CRAIG & ASSOCIATES PTY LTD.

